



DSB Cat-Slide System

- Ideal for low freeboard MES requirements
- Single crew member deployment mechanism
- Compatible with both self-righting and open reversible liferafts



DSB Cat-Slide System

DSB OFFERS COMMITMENT

DSB is a world famous brand within the Survitec Group portfolio and has been the leading developer and manufacturer of innovative survival products for more than 160 years. With unwavering dedication to producing high quality, reliable and ground-breaking products, DSB sets the pace in optimised survival solutions.

DSB products are renowned for their sturdiness of design and longevity. Each individual product; from leisure craft to liferaft, from accessory to custom-built model, is extremely reliable. We set and exceed the highest technical standards for product development and manufacturing with capabilities spanning across Air, Land and Sea survival equipment.

Survitec Group is the world leader in critical safety and survival solutions serving customers in the marine, aviation, energy and defence industries. Headquartered in the UK, the company employs 2000 people across 8 manufacturing sites and operates through a network of around 580 distributors and service stations to bring its highly innovative and award winning products and services to a global customer base. With an extensive history spanning over 160 years and a portfolio of some of the most reputable brands in the safety and survival industry, Survitec is committed to product innovation, technological advancement and quality assurance.

Key products within Survitec's portfolio include marine, defence and aviation liferafts, marine evacuation systems; chutes and slides, submarine escape systems, lifejackets for commercial airlines and the offshore industry as well as pilot flight equipment, including anti-g clothing used for the Eurofighter and JSF programmes. The Group is also a major supplier of fire-fighting equipment, fibre and wire rope, power tools, height safety systems, lifting equipment and inspection services.



DSB OFFERS FLEXIBILITY

Designed principally for smaller ferries and passenger vessels, the DSB Cat-Slide System is a unique system which is ideal for low freeboard vessels. The key to this system is in its simplicity - the operation of the DSB Cat-Slide System is so efficient that only one crew member is required during deployment. The system is extremely flexible, and can be configured to suit the requirements of each vessel.

System options include:

- Full complement of SOLAS compliant self-righting canopied liferafts
- Full complement of open reversible liferafts
- Combination of both canopied and open reversible liferafts
- Configuration with or without the slide



DSB OFFERS SIMPLICITY

The DSB Cat-Slide System is one of the easiest and cost-effective solutions on the market. The simple deployment procedure requires only one crew member for operation and the uncomplicated interface between the rafts and slide ensures straightforward servicing arrangements – again minimising cost. The complete system with liferafts and slides will be inflated, bowsed and ready for boarding in under five minutes. The pictograms below demonstrate the simple yet effective deployment procedures.

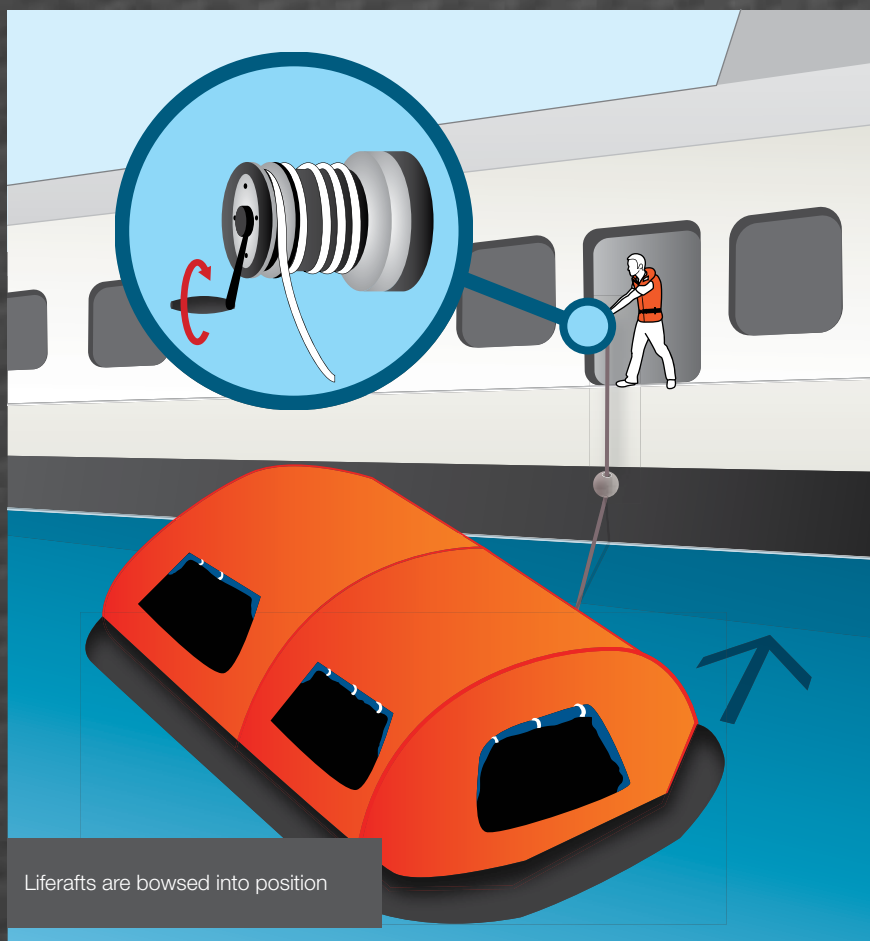
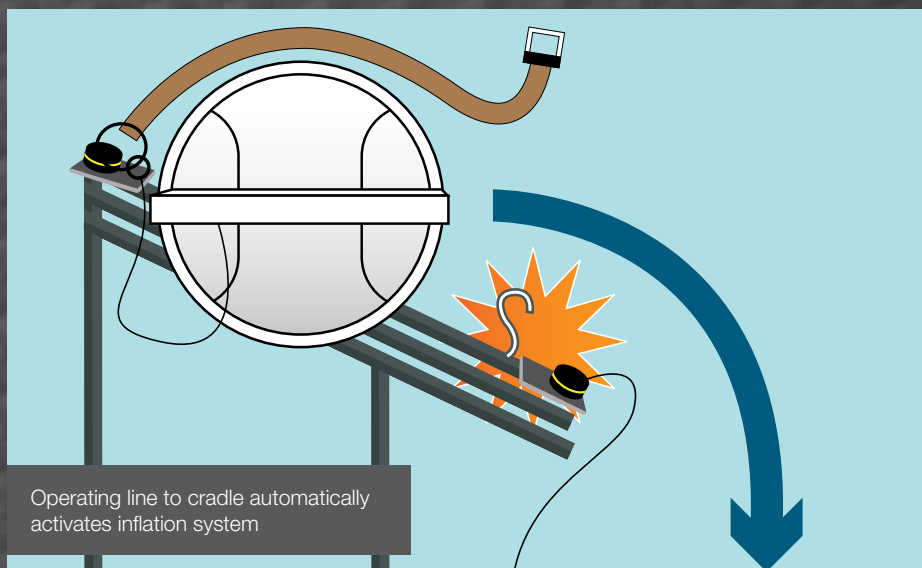
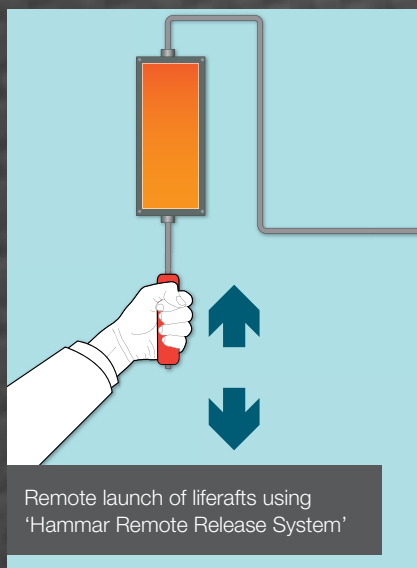

Self-righting rafts

The DSB Cat-Slide System offers multiple passenger capacities by attaching a self-righting liferaft to the main system liferaft during deployment. This ensures DSB systems offer maximum flexibility to suit any low-freeboard vessel.

The table below outlines the configurations available in the self-righting liferaft range.

Self-Righting Liferafts					
				Total Weight (kg)	
Total Capacity	Cat-Slide	Capacity of MES Liferaft	Capacity of Attached Liferaft	'A' Pack	'B' Pack
50 person	1 2 3 4 5	50 person	-	458	272
75 person	1 2 3 4 5	50 person	25 person	688	444
85 person	1 2 3 4 5	50 person	35 person	769	536
102 person	1 2 3 4 5	102 person	-	-	624
127 person	1 2 3 4 5	102 person	25 person	-	796
137 person	1 2 3 4 5	102 person	35 person	-	888
150 person	1 2 3 4 5 6	150 person	-	1315	780
152 person	1 2 3 4 5	102 person	50 person	-	896
204 person	1 2 3 4 5	102 person	102 person	-	1248
200 person	1 2 3 4 5 6	150 person	50 person	1773	1052
300 person	1 2 3 4 5 6	150 person	150 person	2630	1560

Open reversible inflatable liferafts

The DSB Cat-Slide System offers the same flexibility with reversible liferafts as it does with SOLAS canopied self-righting liferafts. The main system liferaft is deployed with the DSB Cat-Slide, and a secondary liferaft can then be attached to increase capacity as necessary. Configurations in this range are as listed below.

Open Reversible Liferafts				
				Total Weight (kg)
Total Capacity	Cat-Slide	Capacity of MES Liferaft	Capacity of Attached Liferaft	HSC Pack
28 person	1 2 3	28 person	-	100
51 person	1 2 3 4 5	51 person	-	160
100 person	1 2 3 4	100 person	-	452
128 person	1 2 3 4	100 person	28 person	552
150 person	1 2 3 4 5 6	150 person	-	594
201 person	1 2 3 4 5 6	150 person	51 person	754
250 person	1 2 3 4 5 6	150 person	100 person	1046
300 person	1 2 3 4 5 6	150 person	150 person	1188

Combination of self-righting and open reversible liferafts

The DSB Cat-Slide System can, in some cases, use a combination of self-righting and open reversible liferafts, dependent upon the approval authority.

Slide

The versatile DSB Cat-Slide System comes in a number of sizes to suit various embarkation heights.

Slide Type	Evacuation Height (m)		Slide Dimension (m)		Packed Valise Dimensions (m)		
	Minimum	Maximum	Length	Width	Length	Width	Height
1	1.5	1.9	2.6	1.08	0.65	0.43	0.31
2	1.95	2.2	3.2	1.08	0.65	0.43	0.31
3	2.25	2.7	3.8	1.08	0.84	0.43	0.34
4	2.75	3	4.4	1.27	1	0.43	0.35
5	3.05	3.4	5	1.27	1	0.43	0.41
6	3.45	3.95	6.4	1.65	1.3	0.43	0.55

KEY OWNER BENEFITS

- Designed for maximum embarkation height of 4m, with slide lengths ranging from 2.6 to 6.4m. Ideal for low freeboard MES requirements
- Simple deployment procedure requiring only one crew member
- Flexibility to be integrated with self-righting or open reversible liferafts
- Liferafts stowed in a cradle arrangement that allows for automatic and remote deployment
- DSB Cat-Slide stowed in a valise next to the evacuation point





- International presence in 96 countries
- 580+ accredited service stations
- 8 world class manufacturing facilities
- 12 contractor logistics support sites for the offshore industry
- 2000 employees

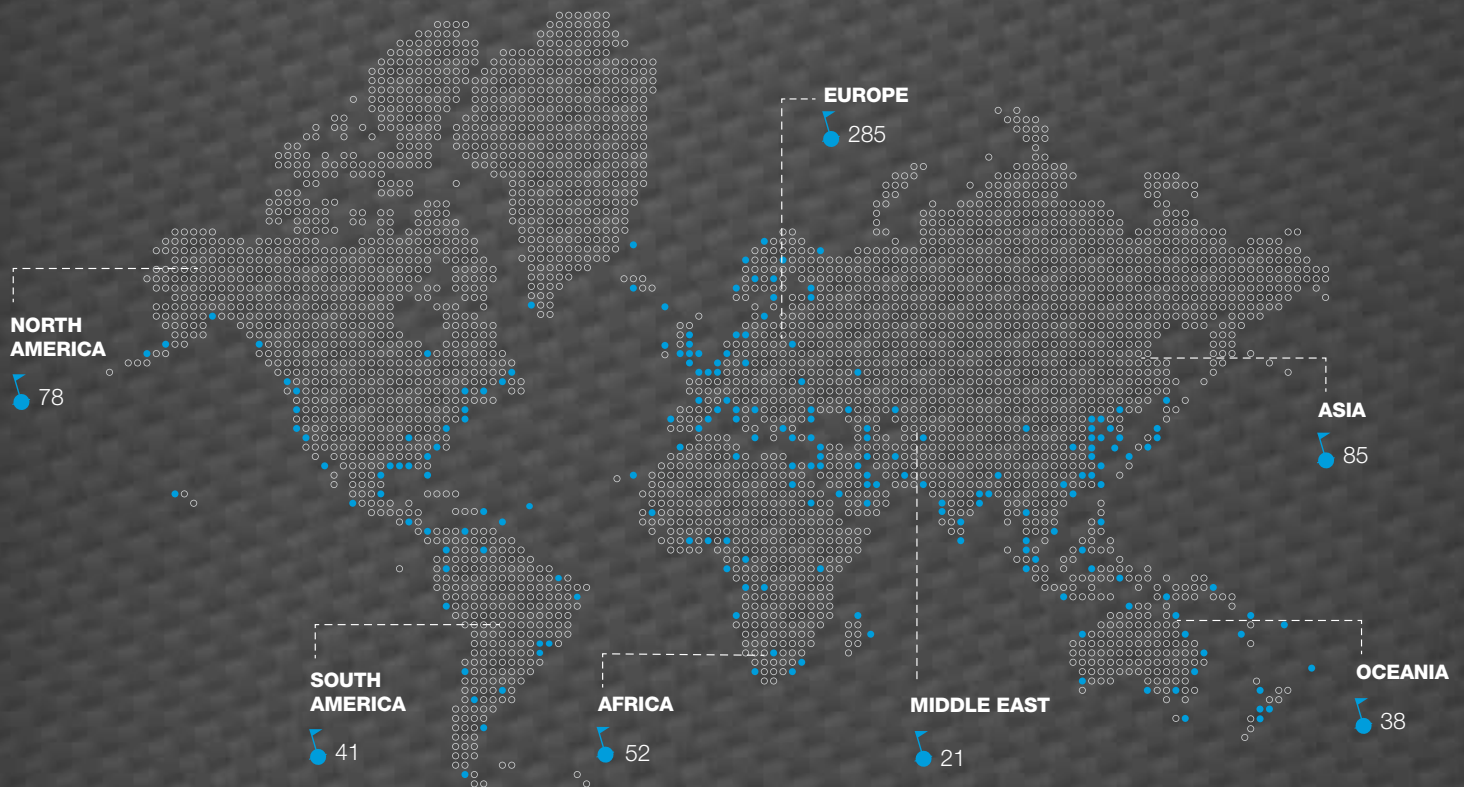

Survitec Group

DSB – Deutsche Schlauchboot GmbH
Angerweg 5, D-37632, Eschershausen, Germany
T: +49(0) 5534 3010
F: +49(0) 5534 301 200
E: eschershausen@survitecgroup.com
W: www.deutsche-schlauchboot.de / www.survitecgroup.com

DSB Cat-Slide System complies with:

Self-Righting Liferrafts:

IMO LSA – Code Chapter IV and VI and IMO Res. MSC.81 (70)

Open Reversible Liferrafts

IMO LSA – Code Chapter VI, HSC – Code 2000 Annex 11 and IMO Res. MSC . 81 (70)

EC Equipment Directive certificates with associated wheelmark



0736/YY
MB 044 REV: 001